



Special Features

- With double flushing ports.
- Suitable with flanged, pancake or inline diaphragm seals.
- Available in all exotic material grades.

Application

- The flushing ring is designed to be sandwiched between the process flange & the diaphragm seal.
- Material collected in front of diaphragm can be flushed out through the flushing ports.

Specifications

Standard Version

Flange Size	:	1/2" to 5" as per ANSI B 16.5
Material	:	AISI 316 SS
Number of ports	:	Two
Port Connection	:	1/4" NPT (F) with Male plug
Sealing Face	:	Suitable to Raised Face of Flange

Dimensions - Standard Version

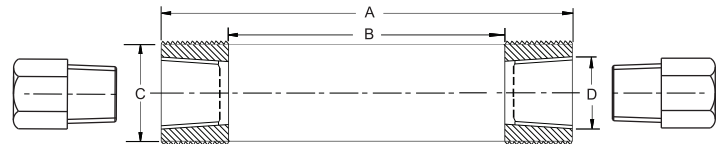

For flange type diaphragm seals

Flange Size	Class	A	B	C	D
1/2"	150 # to 600 #	35	12	30	1/4" NPT or 1/2" NPT (F)
3/4"	150 # to 600 #	43	20	30	
1"	150 # to 600 #	51	25	30	
1 1/2"	150 # to 600 #	73	43	30	
2"	150 # to 600 #	92	62	30	
3"	150 # to 600 #	127	92	30	
4"	150 # to 600 #	157	92	30	
5"	150 # to 600 #	185.5	126	30	

Note: other sealing face and higher pressure rating flushing rings on request. Please specify.

- Notes :
- Drawings are not to scale.
 - All Dimensions are in mm.

How To Order

How To Order						Example		
Basic Model						FLR		
Code								
Optional Extras								
Flange Size (As per ANSI B 16.5)						X OR XX		
1/2"	3/4"	1"	1 1/2"	2"	3"		4"	5"
Flange Rating (Do not select if DA or DB required)						XXX		
150	300	400	600					
Sealing Face						XX		
RF	Raised Face (Standard)		FF	Flat Face			RJ	Tongue and Groove (Ring Joint)
Flushing Ring Material						XX		
SL	AISI 316L SS		CS	Carbon steel			TI	Titanium
HC	Hastelloy C		MO	Monel		S6	AISI 316 SS (Standard)	
Flushing Ports (with two male plugs)						XX		
2N	1/4"NPT (F) (Standard)		4N	1/2" NPT (F)				
Options MTC Material test certificates* TNC Conformity as per NACE Standard						XXX		

* Material test certificates will be provided for wetted parts only with chemical composition testing. For others, please consult factory.

Ordering example: FLR. X OR XX . XXX . XX . XX . XX . XXX

Note : Specifications and dimensions given in this product catalogue represents the state of engineering at the time of printing. Modifications may take place and materials specified may be replaced by others without prior notice.